

## EKA Floor Guide

# A

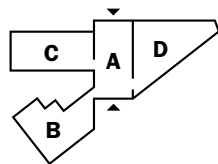

# B

# C

# D

**A5** ☀️ 🚿

Auditorium  
Sea Terrace

**A4** 🚿

Architecture *Students*  
Art *Students*

**A3** 🚿

Drawing  
Painting  
Academic Staff

**A2** 🚿

International Office  
Drawing  
Painting  
Sculpture  
Art and Culture  
*PhD Students*

**A1** ♿️ 🚿

Assembly Hall  
EKA Gallery  
Canteen

**B6** ☀️ 🚿

Ceramics  
Glass Art  
Old Town Terrace

**B5** ♿️ 🚿

Accessory Design  
and Bookbinding  
Jewellery and  
Blacksmithing

**B4** 🚿

Photography  
Photo and Video  
Studio  
Graphic Art

**B3** ♿️ 🚿

Animation  
Scenography  
New Media

**B2** 🚿

Installation and  
Sculpture  
Sculpting Studios  
Prototyping Lab

**B1** 🚿

Woodworking Shops  
Metalworking Shop

**C4**

Architecture and Urban  
Design *Students*  
Interior Architecture  
*Students*  
3D Lab

**C3**

Graphic Design  
Industrial and Digital  
Product Design  
Interaction Design

**C2**

Painting *Students*  
Art and Culture  
*Students, Research Fellows*  
Open Academy

**C1**

Fine Arts *Students*  
Creation of Environ-  
ments *Students*  
Media Graphics  
*Students*

**D6**

Student Council

**D5**

Fashion Design  
Textile Design

**D4**

Architecture *Dean's Office,*  
*Academic Staff*  
Design *Dean's Office,*  
*Academic Staff*  
Art and Culture  
*Academic Staff*  
Art Didactics

**D3**

Art and Culture *Dean's*  
*Office, Academic Staff*  
Fine Arts *Dean's Office*  
Design *MA Students*  
Conservation Studios

**D2**

Rectorate  
Administration  
Academic Affairs  
Psychologist-Career  
Counsellor

**D1**

Library  
EKA Press

